

Voron Design

10 - Assemble Tool Offset Switch and Bed

Written By: ArmyAg08

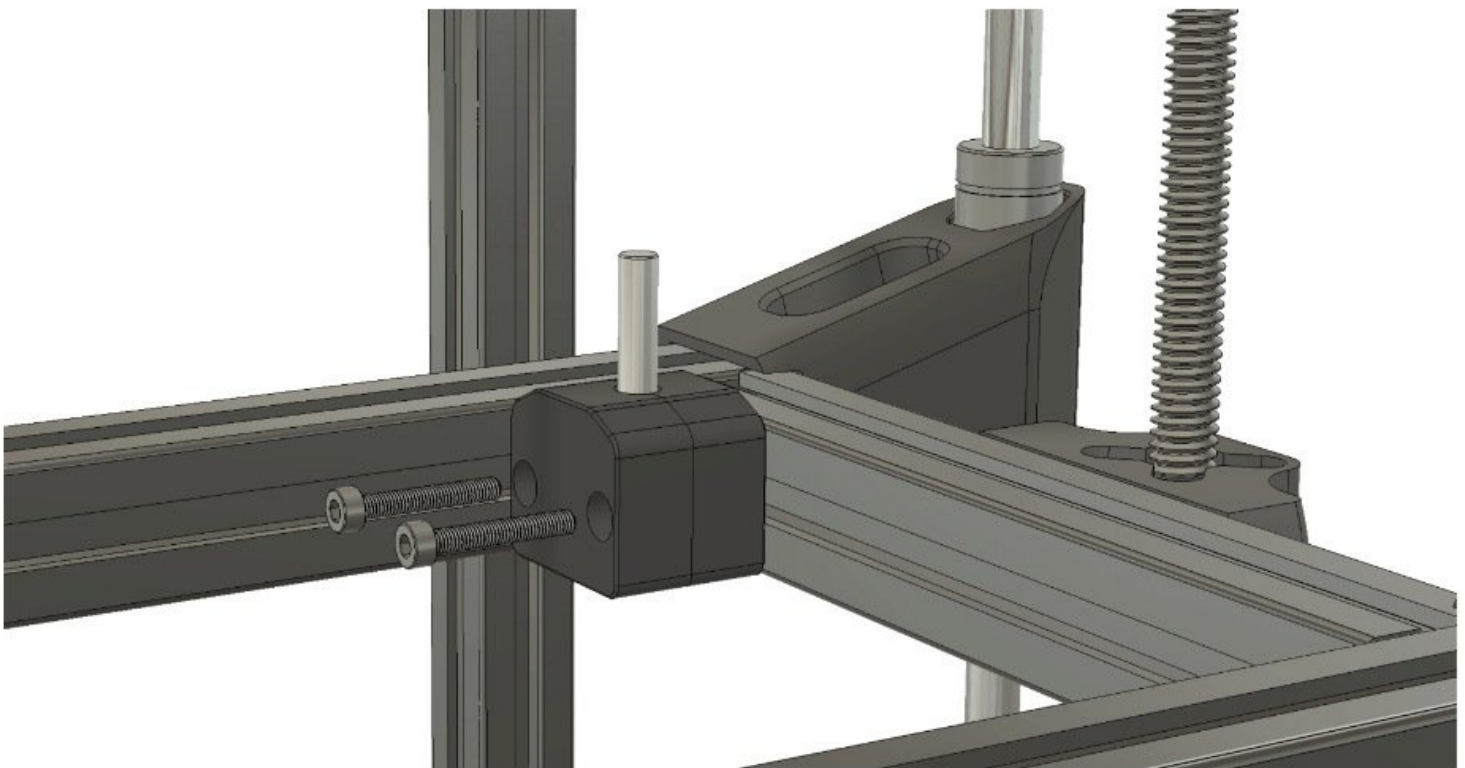

**TOOLS:**

- [Allen Key Set](#) (1)

**PARTS:**

- [5x40mm Shaft](#) (1)
- [FSR Pad](#) (1)
- [Light Sensor Board](#) (1)
- [M3x20 SHCS](#) (6)
- [Spring](#) (4)

Step 1 — Assemble Endstop Pin

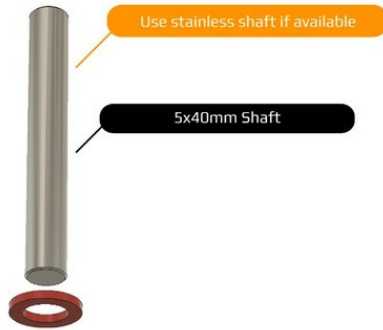

- Printed pin retainer should fit snugly to prevent pin from falling out when machine is flipped.

Step 2 — Apply FSR Pad

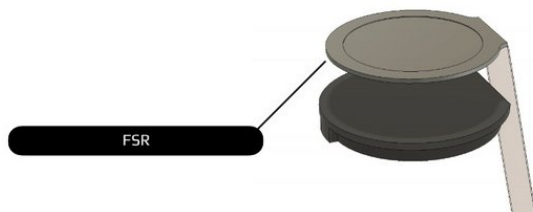

- Most FSR pads have a sticky backing. Peel carefully.

Step 3 — Assemble FSR

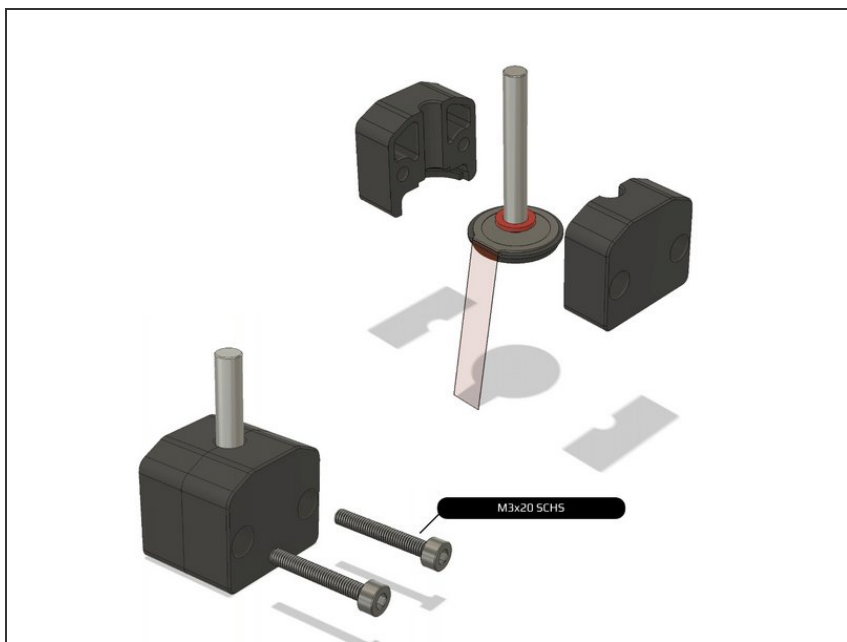

- New line.

Step 4 — Attach FSR to Bed Carrier

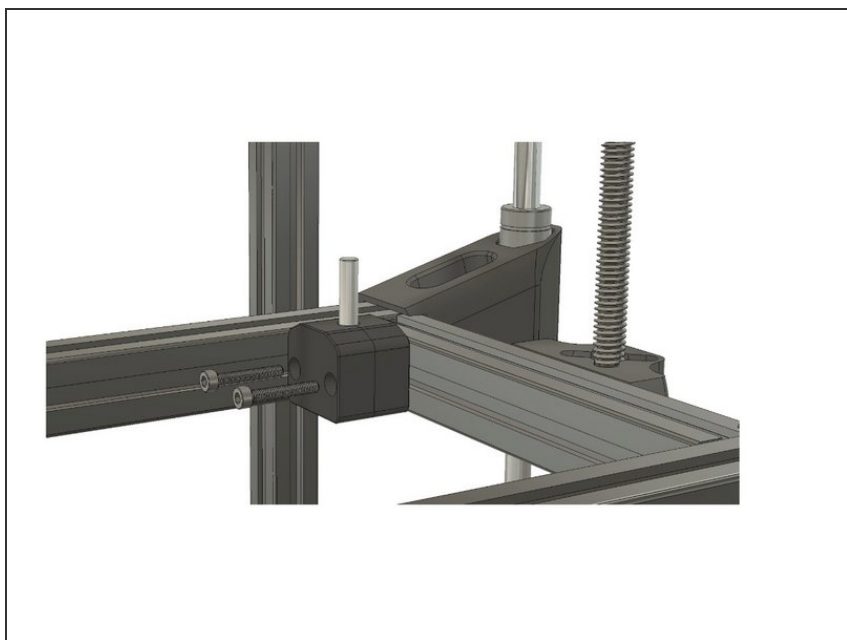

- New line.

Step 5 — Attach Print Surface to Bed Carrier

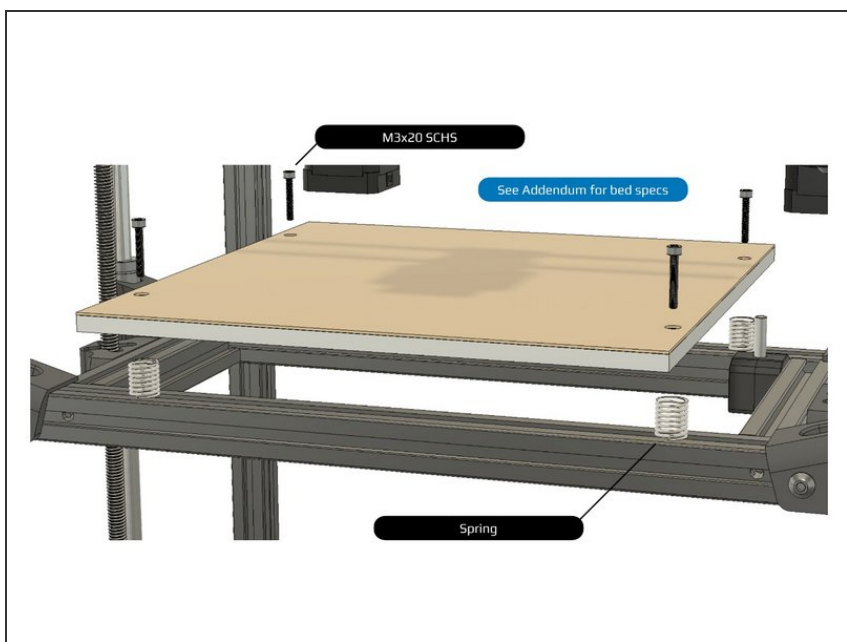

- Bed power wires should be oriented towards the rear of the printer.

Step 6



- [Continue to the Toolhead](#)